

CP156-S

RISER SCREWS

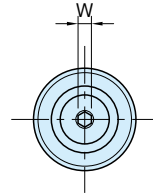
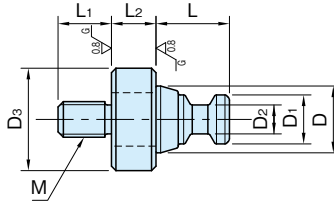

★Key Point
To avoid tool interference!

Clamping Screw	Riser
SCM435 steel Quenched and tempered Black oxide finished	S45C steel Quenched and tempered Black oxide finished Precision ground

Part Number	M	L ₁	D	L	D ₁	D ₂	L ₂ (±0.01)	D ₃	W	Weight (g)	CLAMPING MODULES
CP156-08061S	M 6X1	9	15	16.5	11	6.5	10	23	3	45	CP150-08040, CP151-08080
CP156-08001S	M 8X1.25	12								47	CP152-08050
CP156-12081S	M 8X1.25	12								165	CP150-12063, CP151-12125
CP156-12101S	M10X1.5	15	24	25	16	9.5	17	34	5	170	CP152-12080
CP156-12001S	M12X1.75	18								176	
CP156-16101S	M10X1.5	15								348	CP150-16080, CP151-16160
CP156-16121S	M12X1.75	18	31	33	21	13	20	45	6	354	CP152-16100
CP156-16001S	M16X2	22								372	

Feature

The workpiece can be raised to avoid tool interference with Clamping Module.

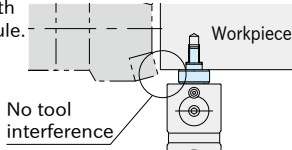

Related Products

- CP150 Clamping Modules (Flanged)
- CP151 Clamping Modules (Double)
- CP152 Clamping Modules (Single)
- CP155-LS Round Tapered Riser Screws
- CP155-DS Diamond Tapered Riser Screws

How To Use

- Can be installed on the workpiece.
- No locating function
- Spacing tolerance of the tapped holes should be ±0.2.

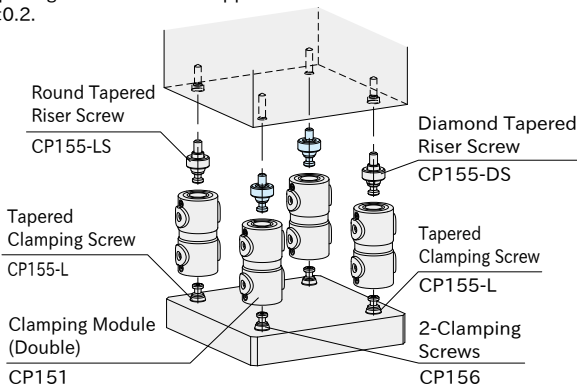

Note

Please check Allowable Cutting Force & Workpiece Weight of CLAMPING MODULES before using.

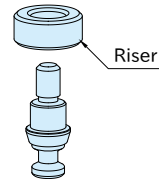

Riser is removable.
Clean the top and bottom surfaces regularly.
Note: Riser may drop from the body of clamping screw.