

CP157

TAPERED BUSHINGS



CP157-L
(Accurate)



CP157-S
(Standard)

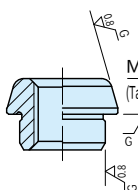

CP157-L
(Accurate)

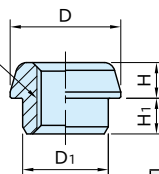

CP157-S
(Standard)

Body	
S45C steel	
Black oxide finished	
Precision ground (only for Accurate type)	

Accurate		Standard		D	H	H ₁	M	Weight (g)	CLAMPING MODULES
Part Number	D ₁ (g6)	Part Number	D ₁ (-0.02/-0.05)						
CP157-06001L	8	CP157-06001S	8	11.5	4	5	M 6×1	4	CP150-06025
CP157-08001L	12	CP157-08001S	12	15.5	5	5	M 8×1.25	8	CP150-08040
CP157-12001L	18	CP157-12001S	18	24.5	8	6	M12×1.75	27	CP150-12063
CP157-16001L	22	CP157-16001S	22	31.5	10	7.5	M16×2	51	CP150-16080

How To Use

- Can be used for mounting **CP150** Clamping Module (Flanged) on the fixture plate.
- Use Accurate Type for precise locating of a clamping module.
- Use Standard Type for rough locating of a clamping module.

Mounting-Hole Dimension

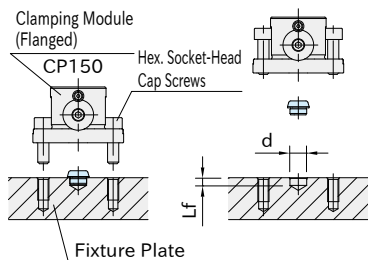

Size	d (H7)	Lf	
CP157	06001	8	5.5
	08001	12	5.5
	12001	18	6.5
	16001	22	8

Note: The tolerance of dimension "d" for Standard Type should be $^{+0.1}_{0}$.

Related Product

- **CP150** Clamping Modules (Flanged)
- **CP155-L** Tapered Clamping Screws (Round)
- **CP155-D** Tapered Clamping Screws (Diamond)
- **CP156** Clamping Screws

Spacing Tolerance

- Spacing tolerance for Accurate Type should be ± 0.02 .
- *) Spacing tolerance for Standard Type should be ± 0.1 .

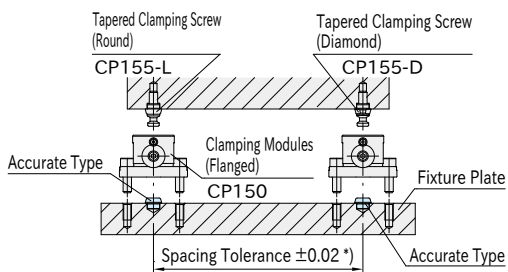

Application Example

