

- Chiave inclusa
- Key included
- Schlüssel beigegeben

Cod. MT	Mandrino Spindle Spindel	I	RPM	Coppia Max Max Torque Max Drehmoment	Lubrificazione int. Coolant through Innenkuehlung	Lubrificazione est. Ext. coolant Ausseenkuehlung	ØD	L	A1	A2	A3	B	CHIAVI NON INCLUDE Keys not included Schlüssel nicht beigegeben		
SAU0070125	ER25	1:1	6000	32Nm	-	X	-	-	80.66	-	-	56	OKU0290009	CHSTER25	-
SAU1060225	ER25	1:1	6000	32Nm	P=70bar	X	-	-	96.66	-	-	72	OKU0290009	CHSTER25	-
SAU0070225	ERA25	1:1	6000	32Nm	-	X	-	-	70.03	-	-	56	OKU0290009	CHUB27	CHTAER25ZC
SAU0071225	ERA25	1:1	6000	32Nm	P=30bar	X	-	-	84.03	-	-	70	OKU0290009	CHUB27	CHTAER25ZC
SAU0070316	WELDON16	1:1	6000	32Nm	-	X	-	-	-	-	66.5	56	-	-	-
SAU0071316	WELDON16	1:1	6000	32Nm	P=30bar	X	-	-	-	-	80	70	-	-	-
SAU0070416	Ø16x17	1:1	6000	32Nm	-	X	16	17	-	59.5	-	56	OKU0290009	CH_VTCROCE_M08	-
SAU0070422	Ø22x19	1:1	6000	32Nm	-	X	22	19	-	61.5	-	56	OKU0290009	CH_VTCROCE_M10	-

SAUTER
VDI 30
MODULO MOTORIZZATO ASSIALE VDI30 DIN 5480
Axial driven tool VDI30 DIN 5480
Axial angetriebenes Werkzeug VDI30 DIN 5480

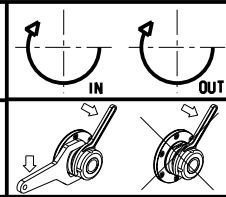

M.T. srl
Via Casino Albini 480
Tel. 0541/956034-957884
Fax 0541/956341
47842 S. GIOVANNI IN M. (RN)
e-mail: mtma@mtmarchetti.com
http://www.mtmarchetti.com



PAGINA SAU017-2-00

Subject to change without notice.